

## 1. I/O interface

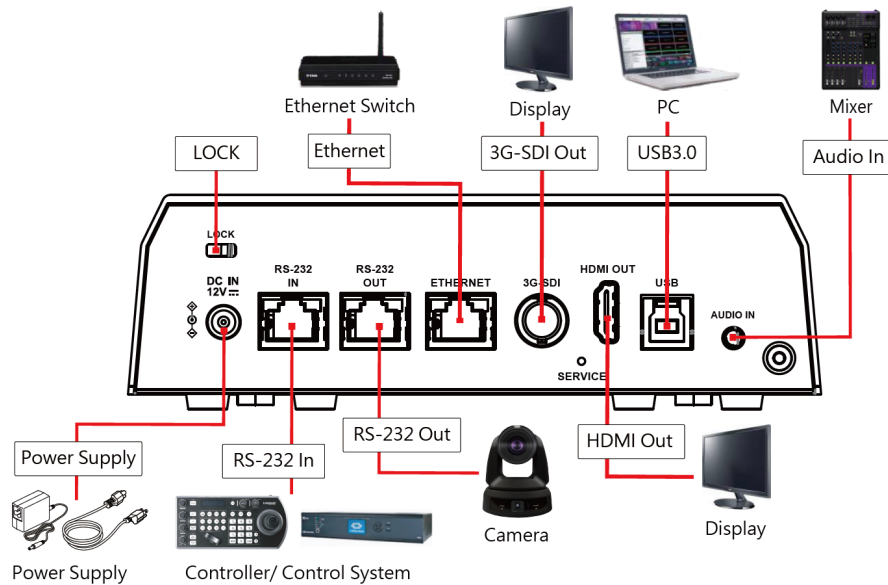

## 2. Precautions for Installation

2.1 Use the provided DC 12V power cord or a PoE router or hub to supply power via a network cable.

\*Camera supports PoE+ (IEEE802.3at)

- Supported tracking distance: 2~18m/ Optimal distance : 8m

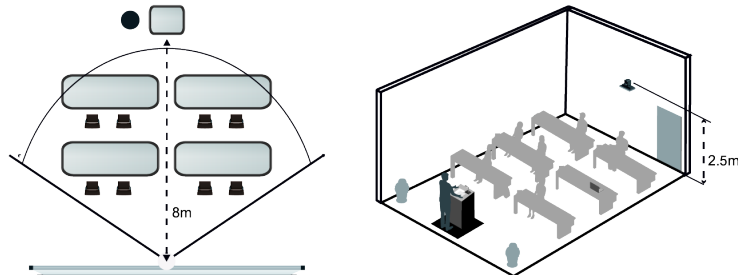

\*For best tracking results, avoid placing images of people on posters or screens behind the subject.

## 3. Installation on the ceiling

4.1 Fix the metal plate A on the camera base with 4 M3 silver screws.

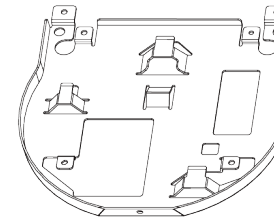

Metal Plate A

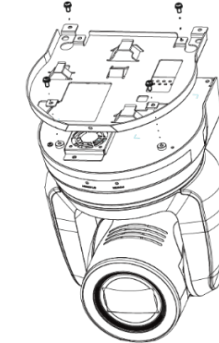

4.2 Lock the metal plate B on the ceiling

**\*Caution:**

- Please use a hanger that has obtained UL security approval.
- Please do not block the cable hole.

4.3 Attach metal plate A to metal plate B

- Raise the camera and metal plate A to the ceiling and then move it to the right to snap it on to metal plate B.
- Finally, secure with 2 M3 silver screws and 1 M3 black screw.

\*Press the [Mirror] button on the remote control to flip the image.

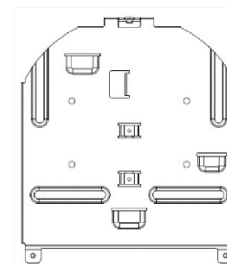

Metal Plate B

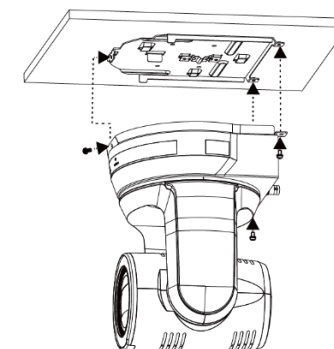

## 4. View Camera Image

### ■ HDMI / 3G-SDI Image Output

Connect a HDMI or SDI cable to output camera video.

\*VC-TR61 default resolution HDMI 2160p 59.94/ SDI 1080p 59.94

### ■ USB Image Output

Connect a USB cable to a computer. Camera can be used as a webcam with video conferencing applications such as Zoom, Microsoft Teams.

### ■ IP Image Output

Connect a Cat5e cable to a router. Log in the web interface to view live image and control the camera.

1. Check Camera IP Address

Default is DHCP is enabled. Use remote control to check IP address by going to [Menu]> [Ethernet]> [IP Address].

\*If connecting the camera directly to a computer, the default IP of camera is 192.168.100.100.

Ethernet	
DHCP	ON
IP Address	192.168.4.68
Subnet Mask	255.255.255.0
Gateway	192.168.4.254

2. Open a web browser, and enter the IP address in the address bar.

3. Enter the account and password to log in.

- Username: admin
- Password: 9999

## 5. Start Tracking

Use the remote control to start the auto-tracking/ auto-framing function.

\* Power / Standby LED flashes green when the tracking function of the camera is activated.

\* Choose either Auto Tracking or Auto Framing function.

### ■ Auto Tracking

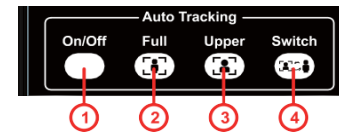

Items	Button	Function
1	On/ Off	Enable / Disable Auto Tracking
2	Full	Camera frames presenter' s full body
3	Upper	Camera frames presenter' s torso
4	Switch	Switch target to a different presenter

### ■ Auto Framing

With Auto-Framing technology, the camera will automatically detect the position of the human body and adjust the person to the center of the screen according to the number of people in the meeting to present the best image and enhance the efficiency of the meeting.



## 6. RS-232/ RS-422 Pin Definition

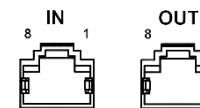

Pin No.	Signal (IN)	Signal (OUT)
3	GND	
4	TX	RX
5	RX	TX
6	DTR	DSR

※For questions about installation, please scan the QR Code.

A support person will be assigned to assist you.



Get Help ?